

**CAM
EQUIPMENT**

TELEPHONE: 01761 434226
FAX No.: 01761 435541
WEB SITE: WWW.CAMequipment.co.uk
E-Mail: Enquiries@CAMequipment.co.uk

FROME HILL, RADSTOCK, Nr BATH, BA3 3PY

MANUFACTURES OF QUALITY GARAGE & WORKSHOP EQUIPMENT SINCE 1972

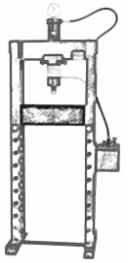

HEAVY DUTY TWO STAGE TRANSMISSION JACKS

The CTJ 500 has been designed to facilitate the safe removal and refitting of Gearboxes, of cars and vans, as well as Medium Trucks.

All these operations can be done by a single operator. Reducing service time and increasing workshop efficiency.

The CTJ 500 is two stage unit with a capacity of 500 kg. Fitted with 4" Nylon Castors for ease of movement, Two Castors are fitted with Brakes.

Safety in use is achieved by four adjustable grip plates, and a Ratchet Strap to secure load.

The lifting Head can be rotated through 360°. The head is also mounted on a slide fitted with Four Ball Races to ease the Back and Forward movement of 100 mm (4") to facilitate re-alignment of the Gearbox when Refitting.

The Lifting Head can be tilted through 30° front and back and 15° from side to side.

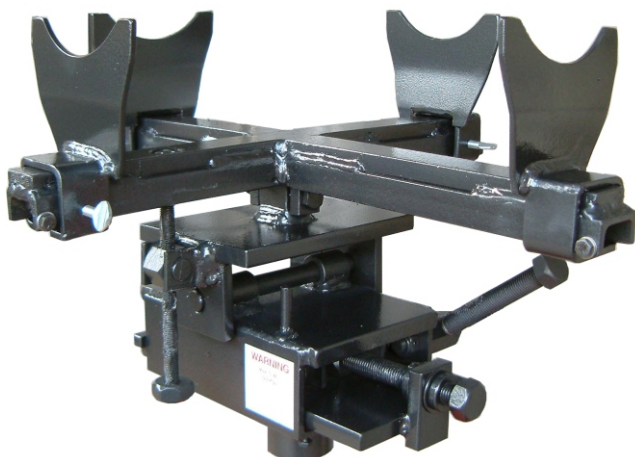

The Base Frame can be supplied in two versions. One Base has standard Even Legs the other version is Asymmetrical, for use on Two Post Lifts. When fitting/removing conventional gear-boxes this Base allows the Transmission Jack base to straddle the cable cover between the two posts of the lift, ensuring the Transmission Jack stands firmly on the floor at all times.

This base can also be used for removal/refitting of front wheel drive units, and because of the two short legs can be used in a standard 30" Pit.

FEATURES

1. Smooth Hydraulic Operation For Precise Raising And Lowering.
2. Pressure Relief Valve Prevents Overloading.
3. Stroke Restriction Valve On Cylinder Prevents Damage When Jack Is Extended To Its Full Limit.
4. Easy Manoeuvring And Positioning Is Achieved By Four Ball Bearing Swivelling Castors Two Castors Are Fitted With Brakes.
5. Ratchet And Web-lashing To Retain Load On Lifting Head.
6. Sensitive Load Lowering By Hand Operated Release.
7. Low Minimum Height, Coupled With Very High Extended Height, Via The Two Stage Hydraulic Ram.
8. Foot Or Hand Operated Fast Acting Pump Causing Less Fatigue To The Operator.
9. Spring Return On The First Stage, Second Stage Returns By Gravity.

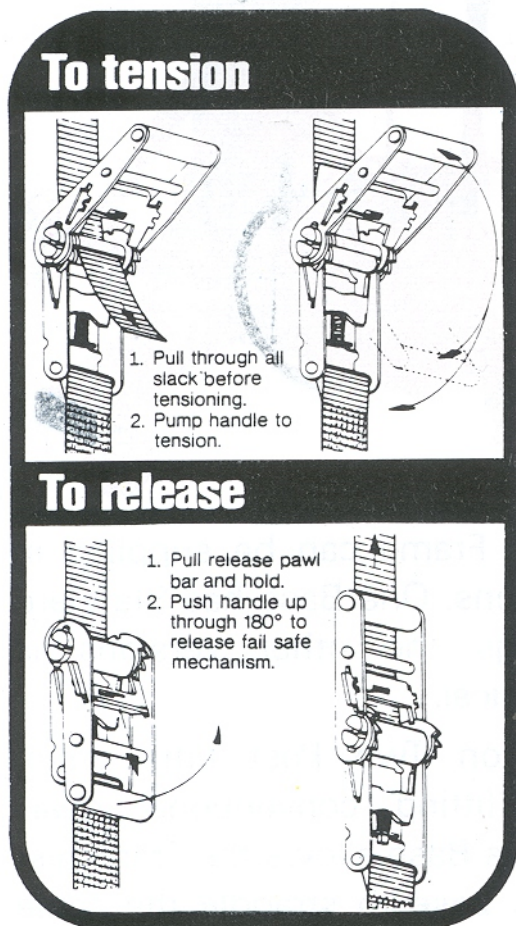

SPECIFICATION

Capacity	500 kg
Minimum Height Overall	1130 mm
Maximum Height Overall	1790 mm
Minimum Height	1050 mm
Maximum Height	1720 mm
Standard Base Dimensions	890 x 890 mm
Asymmetrical Base Dimensions	890 x 1370 mm
Wheel Dia	100 mm
Weight	130 Kg

